

Returned February 9th 1789

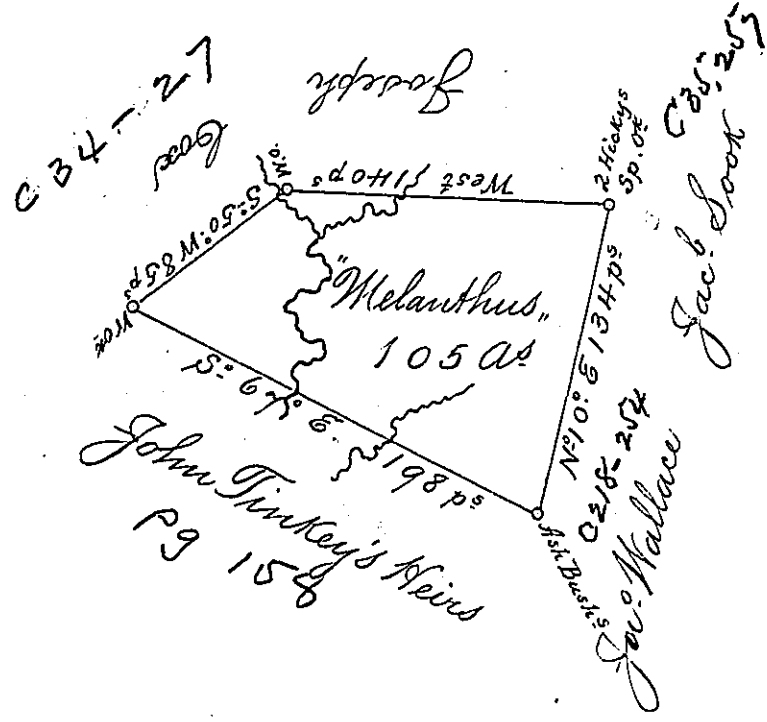

A Draught of a Survey call'd Melanthus ~~is~~ situate on the waters of Pidgeon Creek in Washington County, containing 105 Acres strict Measure, executed Ap^l 29th 1786 for Conrad Nult A^g of Ge^l Sybole in consequence of a Certif^{ic} for 400 A^c granted to S^d Sybole by the Commis^s appointed by Virginia to adjust the Claims to unpatented Lands in the Counties Monong^a Yohg^a & Ohio and duly entered with y^e County Sur^v.
 Entered 18th Feby 1780

Presley Nevill }
 Matthew Ritchie }
 Jⁿ Lukens, Esq^t Sur. Gen^l

IN TESTIMONY that the above is a copy of the original remaining on file in the Department of Internal Affairs of Pennsylvania, made conformably to an Act of Assembly approved the 16th day of February, 1833, I have hereunto set my Hand and caused the Seal of said Department to be affixed at Harrisburg, this first day of April 1902

James W. Latta
 Secretary of Internal Affairs.